

# Omni Ceiling Antenna

## AP-CeilingDM-C-S6-F-WH-1

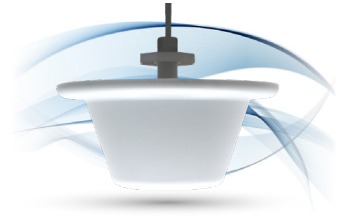

The AP-CeilingDM-C-S6-F-WH-1 is an omni ceiling mount dome antenna, defined by the following features:

- LTE
- Bolt Mount
- Cabled, N-Female
- RoHS Compliant

### Dimensions

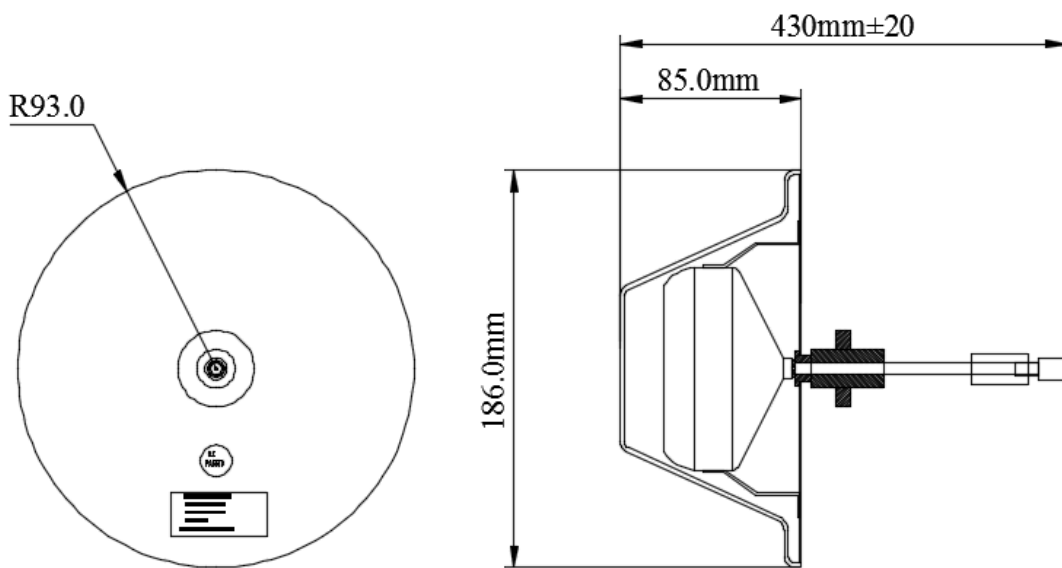

Unless otherwise specified,  
tolerances are +/-2mm

THIRD ANGLE PROJECTION

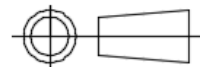

Specifications and Interface		
Frequency Range	698-960 MHz, 1700-2700 MHz	
Peak Gain	698-960 MHz	1.2 dBi
	1700-2700 MHz	5.8 dBi
Max Input Power	50 W	
Feed Impedance	50 ohms	
Polarization	V	
Temperature Range	Operating: -35 °C to +70 °C	
Waterproof Level	IP54	
Lightning Protection	DC Ground	
Dimensions	185 mm × 85 mm	
Weight	0.31 Kg	
Connector	N-Female	

## Antenna Radiation Patterns

**Azimuth XY at 698-960MHz**

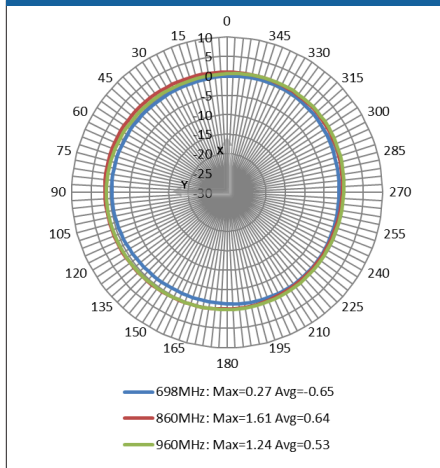

**Side to Side XZ at 698-960MHz**

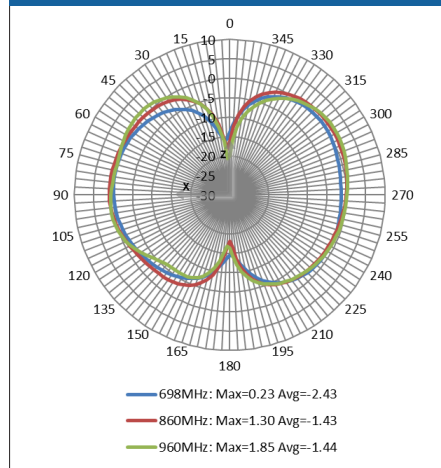

**Front to Back YZ at 698-960MHz**

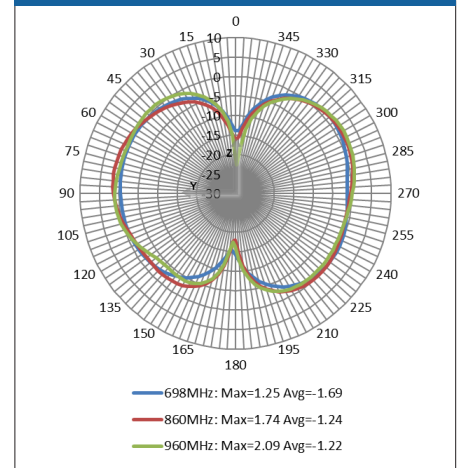

**Azimuth XY at 1710-2700MHz**

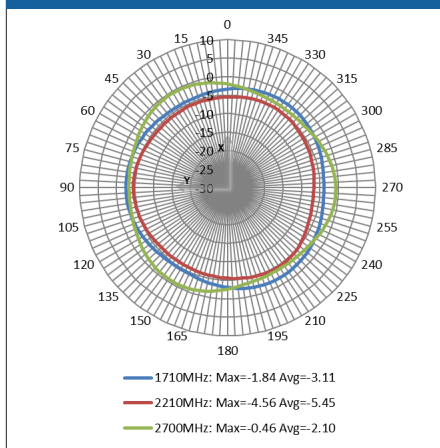

**Side to Side XZ at 1710-2700MHz**

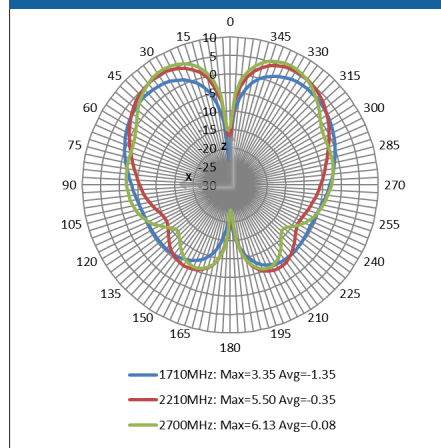

**Front to Back YZ at 1710-2700MHz**

